

Reviewed for Montgomery S.C.D. and meets technical requirements  
 Signature: *Michael J. Smith* Date: 8-27-81  
 U.S. Soil Conservation Service  
 APPROVED FOR SEDIMENT CONTROL AND STORM WATER MANAGEMENT BY MONTGOMERY SOIL CONSERVATION DISTRICT  
 Signature: *Michael J. Smith* Date: 8-27-81  
 DISTRICT PROGRAM COORDINATOR  
 APPROVED FOR MONITOR BY MONTGOMERY SOIL CONSERVATION DISTRICT  
 Signature: *Michael J. Smith* Date: 8-27-81  
 DISTRICT PROGRAM COORDINATOR  
 MSCD APPROVAL OF THIS PLAN WILL EXPIRE ONE YEAR FROM THE DATE OF APPROVAL. THE PROJECT HAS AN ANNUAL RAINFALL DOES NOT CONTINUE ON SITE.

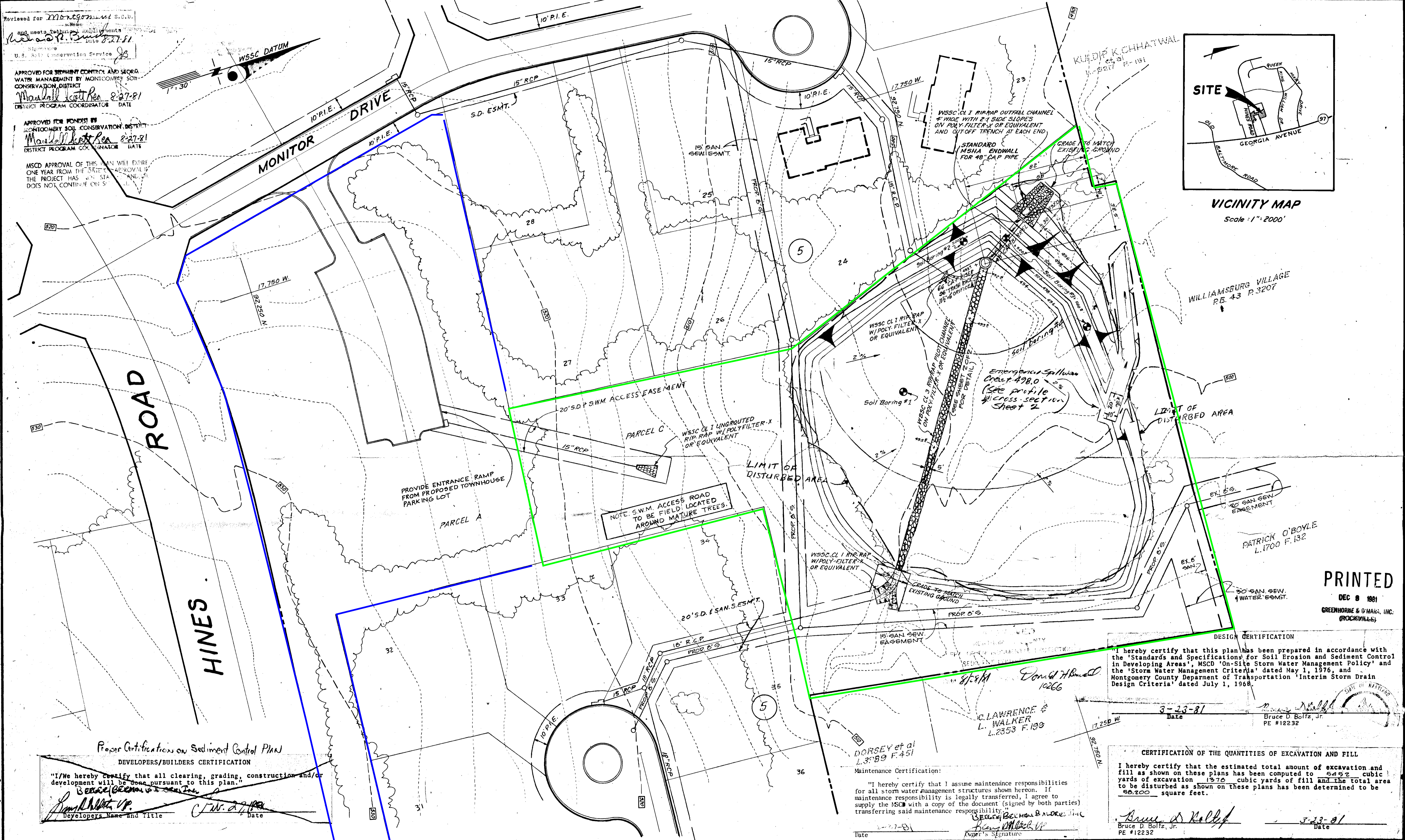
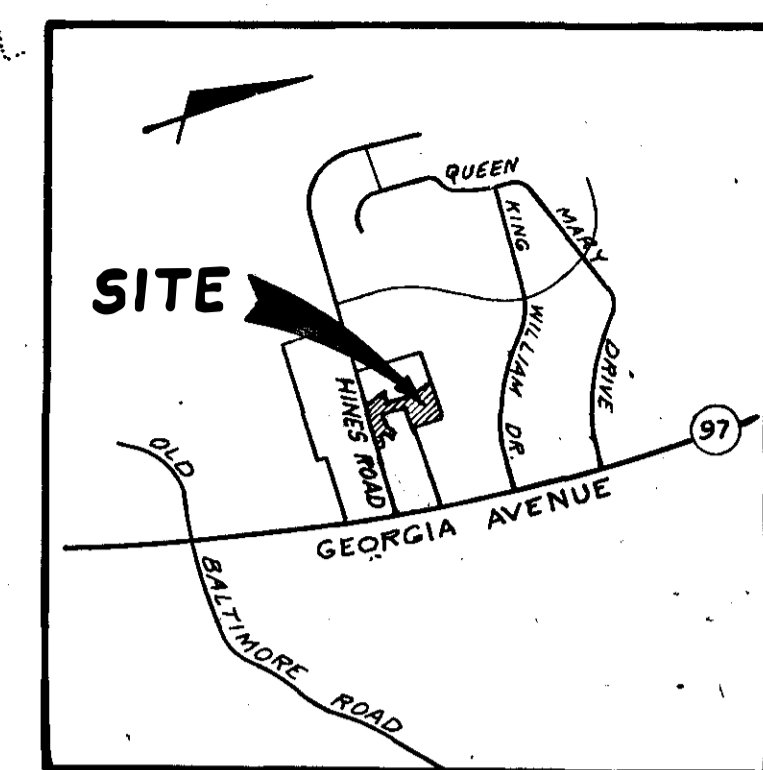

WILLIAMSBURG VILLAGE  
 R.B. 43 P.3207

PATRICK O'BOYLE  
 L.1700 F.132

PRINTED  
 DEC 8 1981  
 GREENHORNE & O'MARA, INC.  
 (ROCKVILLE)

DESIGN CERTIFICATION  
 I hereby certify that this plan has been prepared in accordance with the 'Standards and Specifications for Soil Erosion and Sediment Control in Developing Areas', MSCD 'On-Site Storm Water Management Policy' and the 'Storm Water Management Criteria' dated May 1, 1976, and Montgomery County Department of Transportation 'Interim Storm Drain Design Criteria' dated July 1, 1968.  
 Date: 3-23-81  
 Signature: *Bruce D. Boltz, Jr.*  
 Bruce D. Boltz, Jr.  
 PE #12232

CERTIFICATION OF THE QUANTITIES OF EXCAVATION AND FILL  
 I hereby certify that the estimated total amount of excavation and fill as shown on these plans has been computed to 5452 cubic yards of excavation 1370 cubic yards of fill and the total area to be disturbed as shown on these plans has been determined to be 56,200 square feet.  
 Date: 3-23-81  
 Signature: *Bruce D. Boltz, Jr.*  
 Bruce D. Boltz, Jr.  
 PE #12232

Proper Certifications on Sediment Control Plan  
 DEVELOPERS/BUILDERS CERTIFICATION  
 "I/We hereby certify that all clearing, grading, construction and/or development will be done pursuant to this plan."  
 Signature: *Berger-Derman Builders*  
 Developers Name and Title  
 Date: 2-27-81

Maintenance Certification:  
 I hereby certify that I assume maintenance responsibilities for all storm water management structures shown hereon. If maintenance responsibility is legally transferred, I agree to supply the MSCD with a copy of the document (signed by both parties) transferring said maintenance responsibility.  
 Date: 2-27-81  
 Signature: *Donal H. Arnold*  
 Donal H. Arnold  
 10266  
 Signature: *L. Walker*  
 L. Walker  
 L.2353 F.109

BERGER-DERMAN BUILDERS  
 6101 MONTROSE RD.  
 ROCKVILLE MARYLAND 20892  
 PHONE: 301-770-2200

| No. | REVISION            | DATE    | BY  |
|-----|---------------------|---------|-----|
| 2   |                     | 7-30-81 | MEW |
| 1   | Added MSCD Comments | 4-22-81 | MEW |



**GREENHORNE & O'MARA, INC.**  
 ENGINEERS • ARCHITECTS • PLANNERS • SURVEYORS  
 622 HUNGERFORD DRIVE, SUITE 20, ROCKVILLE, MD.  
 (301) 762 - 5340 20850  
 RIVERDALE, MD. • ANNAPOLIS, MD. • FAIRFAX, VA. • NO. HUNTINGDON, PA.

**STORM WATER MANAGEMENT PLAN**  
**OLNEY CROSSING**  
 OLNEY ELECTION DISTRICT  
 MONTGOMERY COUNTY, MARYLAND

|                |                  |
|----------------|------------------|
| M.C.W. DESIGN  | SCALE 1" = 30'   |
| LJB DRAWN      | 1 OF 2           |
| B.S.P. CHECKED | SHEET            |
| Feb. 1981 DATE | R-395-X FILE No. |
| JOB No.        |                  |